



zFab





**SUSTAINABLE
AFFORDABLE
PRACTICAL
ALL IN ONE PACKAGE**

A new way of thinking, for the design and environmentally conscious owner, about the construction and delivery of prefabricated dwelling/accessory units.

Our quality designed homes are manufactured, delivered, and installed on your site. This minimizes cost, waste and increases efficiency and its delivery.

From purchasing to moving into your home, the zFab process is designed to be as seamless as possible. You can enjoy your zFab in as little as four months.

Each zFab is manufactured with an option for LEED certification with net zero or net positive energy. In addition, a solar panel system and a rain catching tank are sustainable options that can be incorporated with your new home.

<p>ENJOY IN</p> <p>4</p> <p>MONTHS</p>	<p>SUSTAINABLE</p> <p>2</p> <p>OPTIONS</p>	<p>OPTION FOR</p> <p>LEED</p> <p>CERTIFICATION</p> <p>WITH</p> <p>NET ZERO</p> <p>OR NET</p> <p>POSITIVE</p> <p>ENERGY</p>
---	---	--

THE zFab HOUSING DELIVERY MODEL



PURCHASE PROCESS

The purchase process is quick and seamless. Provide us your information, the zFab model that interests you, any optional features you want to include and the destination of the zFab. Brett Zamore Design (bZD) can then begin to establish a feasibility of delivery to your site with a total cost structure. A signed contract with initial deposit will be requested in order to move forward with site design and construction of the zFab. We will support you from the beginning to completion.

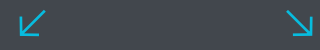

SITE DESIGN + PERMITTING (if requested)

Locating the zFab on your site is critical to the success of your project. We can prepare a site analysis to make sure your home is located in the most optimum location. Local jurisdictions may require obtaining permit before construction. We can help prepare required drawings and paperwork for permitting approval.

MANUFACTURING

Two options of construction are utilized in building the units in order to minimize cost, waste and increase efficiency and delivery. The first and preferred process is a prefabricated unit that is factory-built and delivered to site. The second is a site built structure (used due to problems of permitting and/or delivery) whose construction is made from a kit of parts.

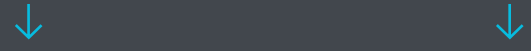

SITE PREPARATION + FOUNDATION

Prior to the zFab delivery, the site needs to be cleared for accessibility and ease of delivery. bZD will also make sure all the utilities are in place and the foundation is installed to the engineer's specification.

SHIPPING

The zFab unit will be wrapped for protection at the factory and shipped from the manufacturer to your site. Based on location, cost and time on shipping will vary.

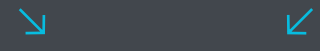

SITE INSTALLATION

The zFab is connected to its foundation and all utility connections are made. Electrical, plumbing and mechanical are ready to go. Optional porches are built depending on the client's need. Site work and landscaping to be completed by others. Options: Solar panels and also a rain collection tank.



MOVE IN/COMPLETION

Now the zFab housing is move-in ready!

zFab 360

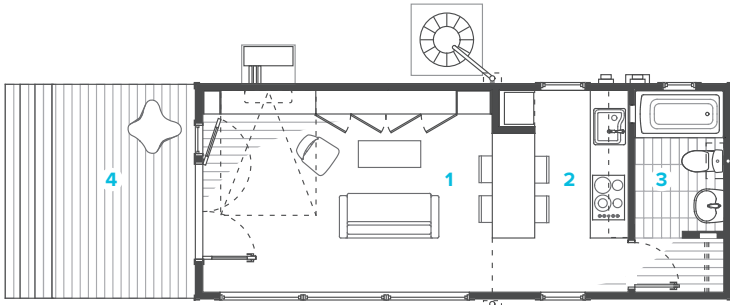

1 Living / Bedroom 2 Kitchen / Dining 3 Bathroom 4 Deck 0' 1' 2' 4' 8'

SQUARE FOOTAGE: 360 sf [12'x30'] + 96 sf deck

RETAIL PRICE: Quote Upon Request *1

SHIPPING: TBD *2

*1 Site preparation, foundation, deck installation, site utilities, mechanical equipment, MEP connections & landscaping to be additional. Pricing by general contractor.

*2 Costs vary due to shipping distance and site accessibility. Pricing estimation for 150 mile radius to be 3,500 USD.



zFab 504

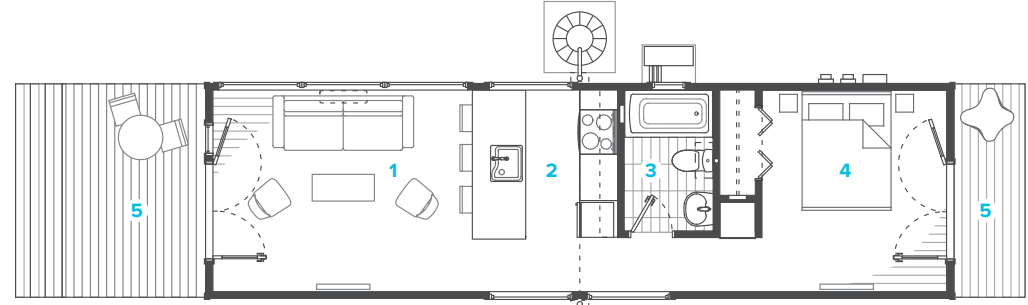

1 Living / Dining 2 Kitchen 3 Bathroom 4 Bedroom 5 Deck 0' 1' 2' 4' 8'

SQUARE FOOTAGE: 504 sf [12'x42'] + 144 sf deck

RETAIL PRICE: Quote Upon Request *1

SHIPPING: TBD *2

*1 Site preparation, foundation, deck installation, site utilities, mechanical equipment, MEP connections & landscaping to be additional. Pricing by general contractor.

*2 Costs vary due to shipping distance and site accessibility. Pricing estimation for 150 mile radius to be 3,500 USD.



zFab 360
Additional living space at your residence



zFab 504
Off-the-grid tranquility



zFab 360
Interior view



zFab 504
Interior view



“A sustainable building, or green building is an outcome of a design philosophy which focuses on increasing the efficiency of resource use—energy, water, and materials—while reducing building impacts on human health and the environment during the building’s lifecycle, through better siting, design, construction, operation, maintenance, and removal.”

—Anne Freji of the Urban Land Institute

WHICH MODEL WILL YOU CHOOSE?

 **brettZAMOREDESIGN**

P 713 623 1926

E office@brettzamoredesign.com

BRETTZAMOREDESIGN.COM

 **brettZAMOREDESIGN**

BRETTZAMOREDESIGN.COM